

# LTS-3DPC24200-12S

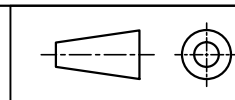

产品型号	LTS-3DPC24200-12S
驱动方式	PWM型
调节等级	256级
输入	AC100~240V 50/60Hz
总输出功率	200W
具备通讯、触发功能	

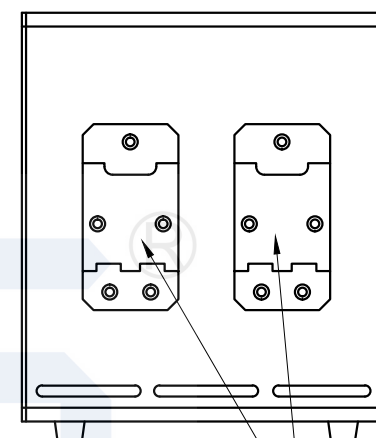
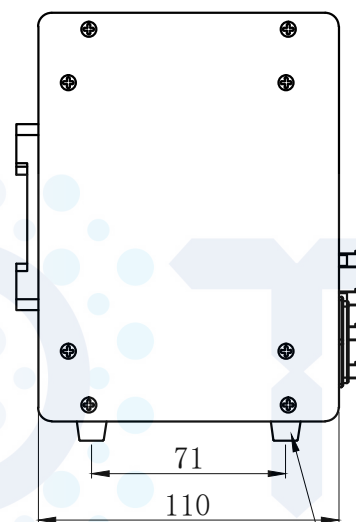
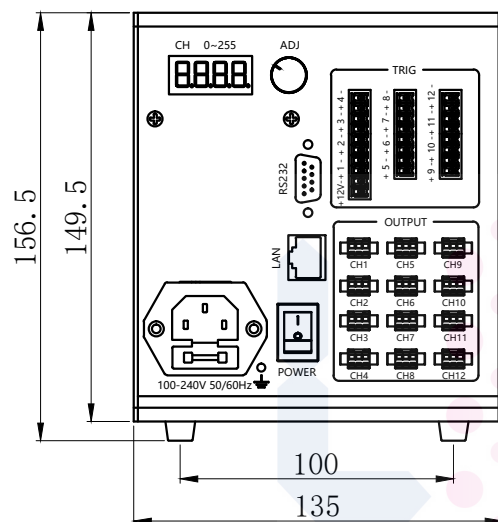

DIN导轨安装座

4-M3 (4个支脚拆后可作安装孔)

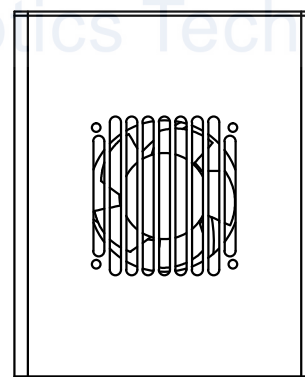

Lighting & Optics Tech Specialist